



Installation and Maintenance Instructions

THESE INSTRUCTIONS MUST BE READ FULLY BEFORE COMMENCING INSTALLATION

HSSD82S STAINLESS STEEL MANUAL SOAP DISPENSER

Features:

Fabricated Stainless Steel Grade 304.

1.0 GENERAL

Suitable for the shower, bathroom, kitchen or workplace.

Parts:

1. Button
2. Viewing port
3. Housing
4. Cover
5. Key
6. Mounting Bracket

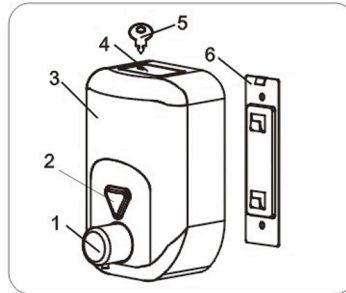

Specification: Volume 820 ml
Per measure – 1ml

Contents: Soap Dispenser, fixing bracket, 2 x fixing screws, 2 x wall plugs and 1 x key.

2.0 INSTALLATION

1. Unlock the cover with the key, using a screw driver loosen the screw and remove the mounting bracket.
2. Using the mounting bracket as a template, mark and drill two holes in the wall and fix the bracket to the wall using wall plugs and fixing screws.
3. Fit the soap dispenser to the mounting bracket.
4. Fill the container with liquid soap, shower gel, body lotion.
5. Fit lid and lock to keep secure.

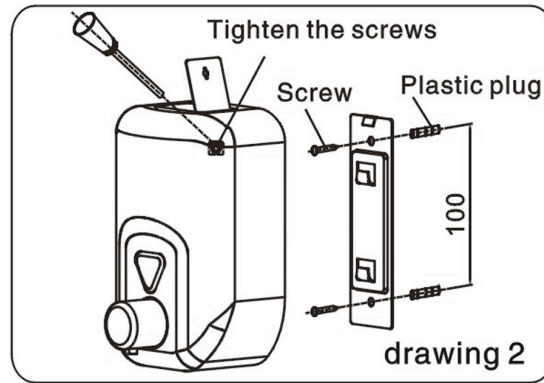
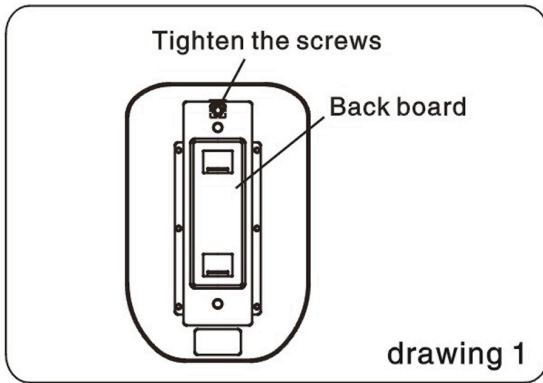

GUARANTEE

HYDOR or its agents will, within a period of 1 year from the date of dispatch from their works, repair or, at its option, replace any goods, which are proven to have defects as a result of defective materials or workmanship. The goods MUST be returned to HYDOR, carriage paid, for examination.

Hydor Ltd.

8 Parkers Close, Downton Business Centre
Downton, Salisbury, Wiltshire
SP5 3RB, UK

TEL: +44 (0) 1725 511422 FAX: +44 (0) 1725 512637 email: info@hydor.co.uk

Hydor Ventilation Aust

42-62 Pound Road West
Dandenong South
Vic 3175

TEL: 1300 655 730 FAX: 1300 134 319 email: info@hydor.com.au

Hydor Ventilation SA

11 Ingrid Road
Montague Gardens
Capetown
7441

TEL: +27 (0) 21 552 1077 FAX: +27 (0) 21 552 2797 email: info@hydor.co.za