

## HIMF Mixed Flow Fans

IP44  
protection

50°C  
temperature

A number of growers on a budget like to take advantage of smaller, more restricted spaces. Our HIMF fans are ideally suited for these grow room requirements, yet still powerful enough to extract up to 929 m<sup>3</sup>/hr of air with low noise levels.



product information	Outlet Diameter	Airflow (L/s) max		Static Pressure (Pa) max		Power Watts		Sound Pressure dBA @3m	
		High	Low	High	Low	High	Low	High	Low
HIMF100	100mm	65.6	57.4	176	164	32	33	45	44
HIMF125	125mm	95.7	82.6	157	143	34	33	44	43
HIMF150	150mm	163.2	124.4	176	227	69	58	55	50
HIMF200	200mm	258.9	222.3	236	223	120	106	53	51

### dimensional drawing

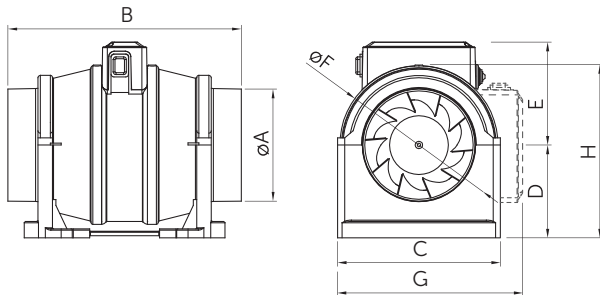

### HIMF with easi cable

Ready to run EASI models, supplied with 1.5 metres of flexible cable, two speed high / low & off switch, and fitted with a 13amp 3 pin plug.

dimensions	A	B	C	D	E	F	G	H	Weight kg
HIMF100	97	296	179	104	113	174	154	139.6	2.4
HIMF125	124	256	179	102	113	174	154	139.6	2.4
HIMF150	147	300	195	112	127	188	182	170	3.0
HIMF200	198	310	254	129	146	228	272	243	4.0

accessories	Fixed Grille	External Gravity Shutters	Internal Extract Valve	Internal Supply Valve	3m Flexible Aluminum Duct
HIMF100	HEG100	HES100	HEV100	HSV100	HFD100X3
HIMF125	HEG125	HES125	HEV125	HSV125	HFD125X3
HIMF150	HEG150	HES150	HEV150	HSV150	HFD150X3
HIMF200	-	-	HEV200	HSV200	HFD200X3